

Product Specification



Model: AP-054RF

Name: 4-key RF Iron Shell Key

[Brand]: AIPIN-TECH

[Product name]: 4-key RF Iron Shell Key

[Model]: AP-054RF

[Operating voltage]: DC 12-24V

[Product weight]: 230g

[Controllable light bar]: 20 meters per 10 meters amplifier can be infinitely connected to the light bar

● Overview

The four-button remote controller can be applied to a variety of lamps, such as: LED advertising module, point light source, soft light bar, wall washing lamp, glass curtain wall lamp, etc.; It has the advantages of convenient wiring, simple use, etc.; It has the function of power-off memory, avoiding frequent setting.

● Features

1. Input voltage adaptive DC12 ~ 24V, with input polarity protection function.
2. Advanced PWM (pulse width modulation) control technology is adopted, with fine change effect and no flicker.
3. Strong driving load capability, maximum current up to 30A, stable performance.
4. Wireless infrared remote control, no direction, remote control distance is not less than 20m.
5. The remote controller has low power consumption and long standby time.
6. It Has Memory functions such as color, mode, speed and brightness.
7. The appearance is novel, beautiful and elegant, especially suitable for indoor home and commercial places.

● Technical parameters

Complete machine	
Operating temperature	-20°C~60°C
Operating voltage	DC 5-24V
Output mode	Common positive connection
Output Control mode	PWM
Packing size	L115*W92*H47mm
Control mode	Infrared signal
Weight (gross weight)	310g
Output power	5V<150W,12V<360W,24V<720W

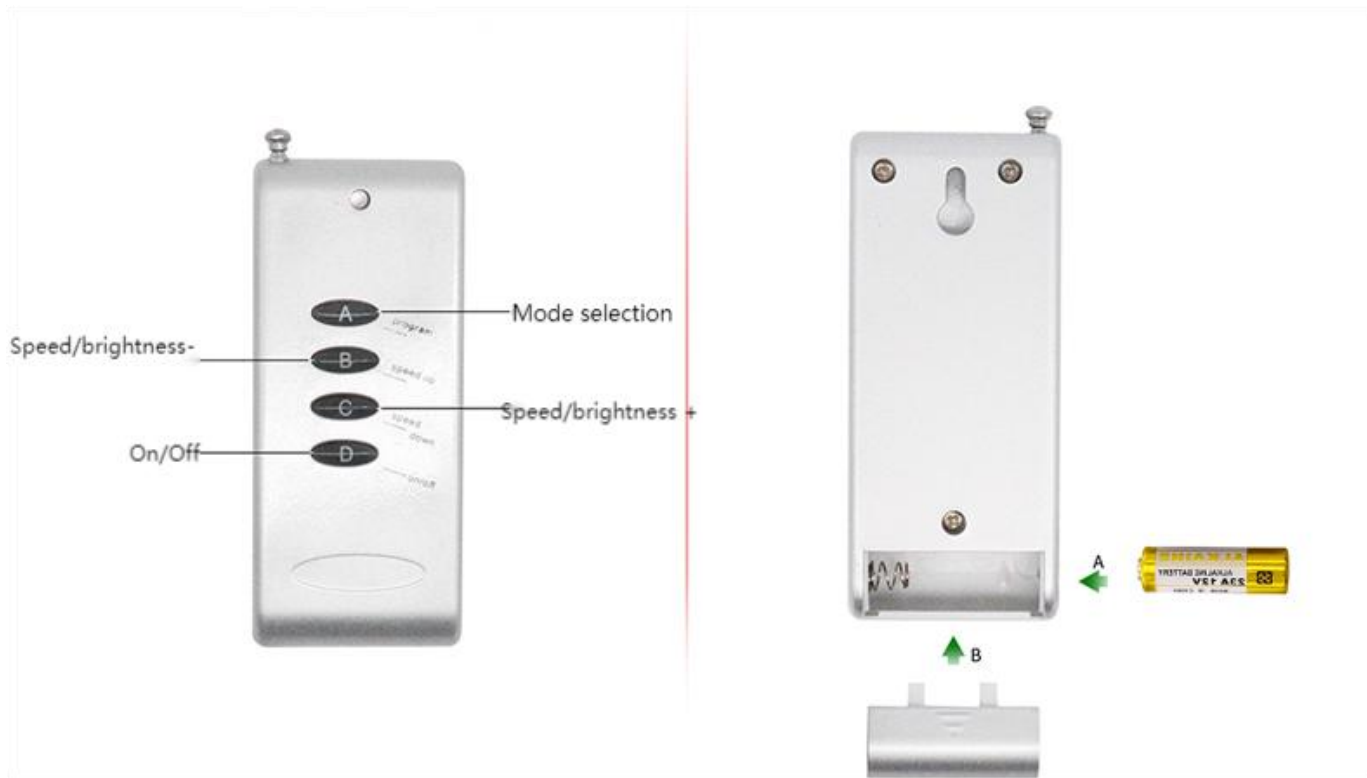

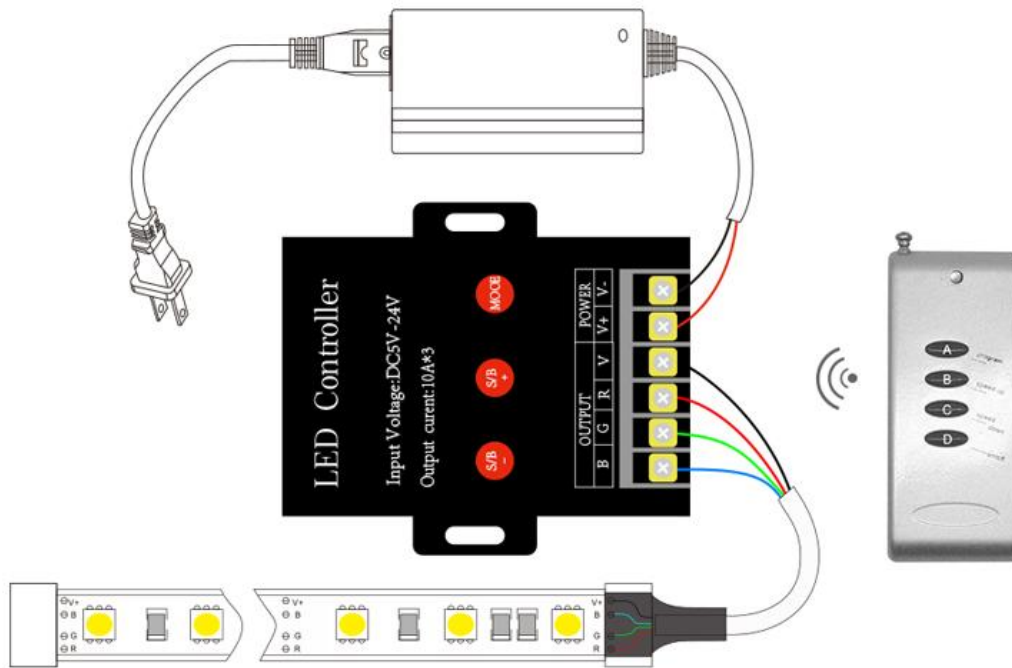

Controller size	Remote control size	Box size	Weight/set	Carton size	Weight/box
L130*W65*H25mm	L90*W41*H20mm	L115*W95*H48mm	310g	L420*W290*H300m m	15.75kg

● Installation Precautions

1. Please debug and install this product by personnel with professional qualifications.
2. This product cannot be waterproof and needs to avoid sun and rain. If installed outdoors, please use a waterproof tank.
3. Good heat dissipation conditions will prolong the service life of LED controller. Please install the product in a well-ventilated environment.
4. Please do not install and use such products in lightning, thunder, strong magnetic field or high voltage.
5. Please check whether the output voltage of the LED power supply used meets the requirements of the product voltage range.
6. The diameter of the used wire must be sufficient to load the LED lamps connected, and ensure that the wiring is firm to avoid accidents caused by overheating of the wire or

poor contact.

7. Before power-on and debugging, ensure that all wiring is correct to avoid lamp damage caused by wiring errors.

● After-sales service

1. Our LED controller products provide lifetime technical support and warranty services:

- Free warranty: if there is any quality problem within one year from the date of purchase, our company will provide free repair or replacement service.
- Paid warranty: a certain cost of repair materials will be charged for products beyond the free warranty period.

2. The following conditions are not covered by free warranty or replacement services:

- Excessive high voltage, overload, improper operation and other man-made damages.
- Any wiring errors, water immersion (non-waterproof products) and unauthorized maintenance.
- Any serious damage or deformation of the appearance caused by transportation or knocking.
- The appearance of the product is seriously damaged or deformed.

Damage caused by natural disasters and force majeure, such as earthquakes, floods, fires, etc.

3. The company's greatest responsibility for ex-factory products is to replace products of the same model and quantity.

4. In order to speed up the maintenance or replacement time, please indicate the failure phenomenon, use environment and operation when the failure occurs to repair the product, so as to ensure that the maintenance situation can be handled quickly.